

## THE SINK NOELSE

D4480-S undermount sink (Large type W800×D440×H180 mm)



### Features

Custom single bowl

(Counter top panel sold separately, Drainage set sold separately, Faucet not included)

### Customize

Size of the sink: each part can be ordered in 1mm increments.

Rounded corner finish available (Solid surfaces only)

Faucet opening location.

Accessories: sink plate cover, and dish drying plate sold separately.

### Material / Finish

Choose a material and surface finish from the below brands.

(DEKTON, Laminam, Neolith, Silestone, Caesarstone, Dupont Corian, HI-MACS, Staron, etc.)

## Dimensions

The below drawings in inches(millimeters) show the standard size.

\*The dimensions of the width and depth indicated on the drawing represent the opening dimensions of the tabletop. The dimensions on the cross section diagram indicate the external dimensions.

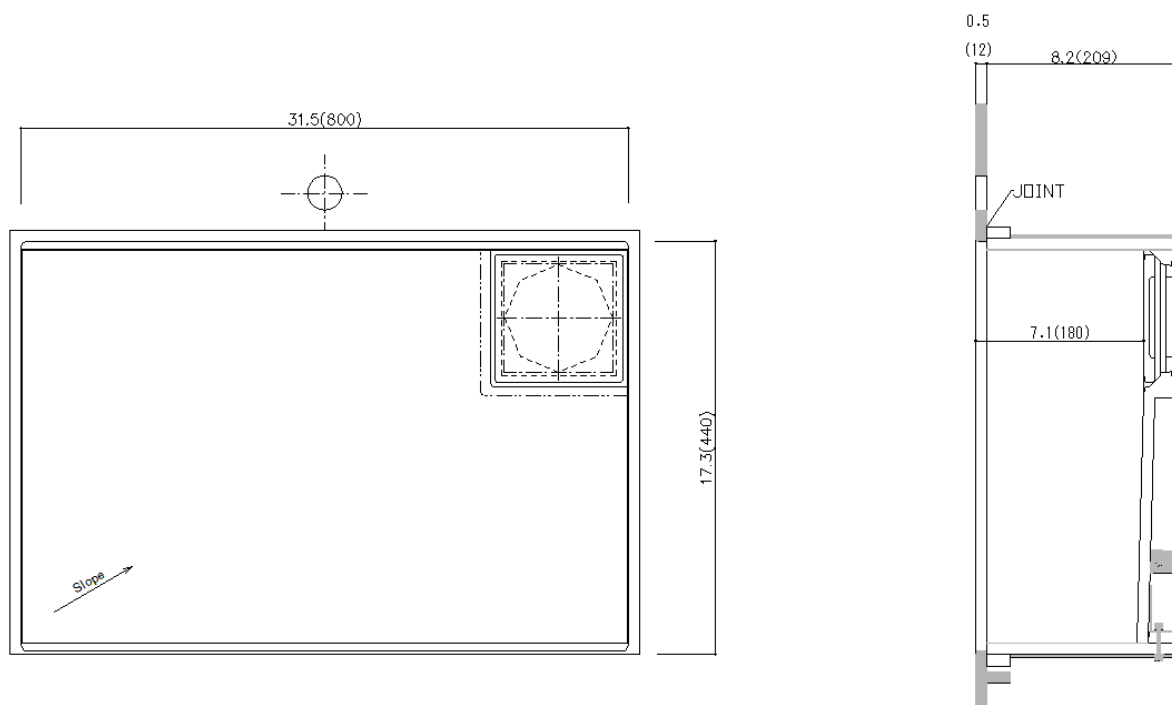

Utility model registration No. 3214697, Design registration No. 1642438  
Trademark registration No. 6188765

Official Distributor (USA & Canada)  
IPPIN PROJECT / CRAFTS Inc.  
contact@ippinproject.com  
www.ippinproject.com

DAINICHI KASEI KOUGYOU CO., LTD.  
Head office : 47-15, 4-chome, Izumi, Suginami-ku, Tokyo, 168-0063, Japan  
Oyama factory : 1946, Awanomiya, Oyama, Tochigi Pref, 329-0201, Japan  
TEL +81-3-3313-5245 <http://www.dainichikasei.com>